

ELM PLAZA

SHOPPING CENTER

Waterville, Maine • Just off Interstate 95

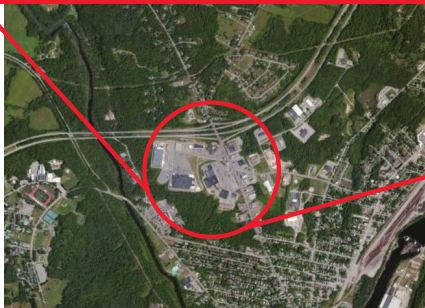

Right
off the
I-95
Ramp

Located
in a busy
retail
district

The Elm Plaza Shopping Center is located on Main Street in the heart of Waterville's Best Retail corridor just off of Interstate 95.

It has approximately 296,126 Square Feet of Retail Space with a J C Penney, Hobby Lobby and Hannaford Supermarket as well as many fine small stores. The Main Street area has over 1,000,000 Square Feet of Retail including a Super Wal Mart, Home Depot, Staples, and Ruby Tuesday!

Contact: Maine Crossroads LLC

Andy Rosenthal

Cell 207 415 0846

www.mainecrossroads.com • andy@mainecrossroads.com

Detailed property overview

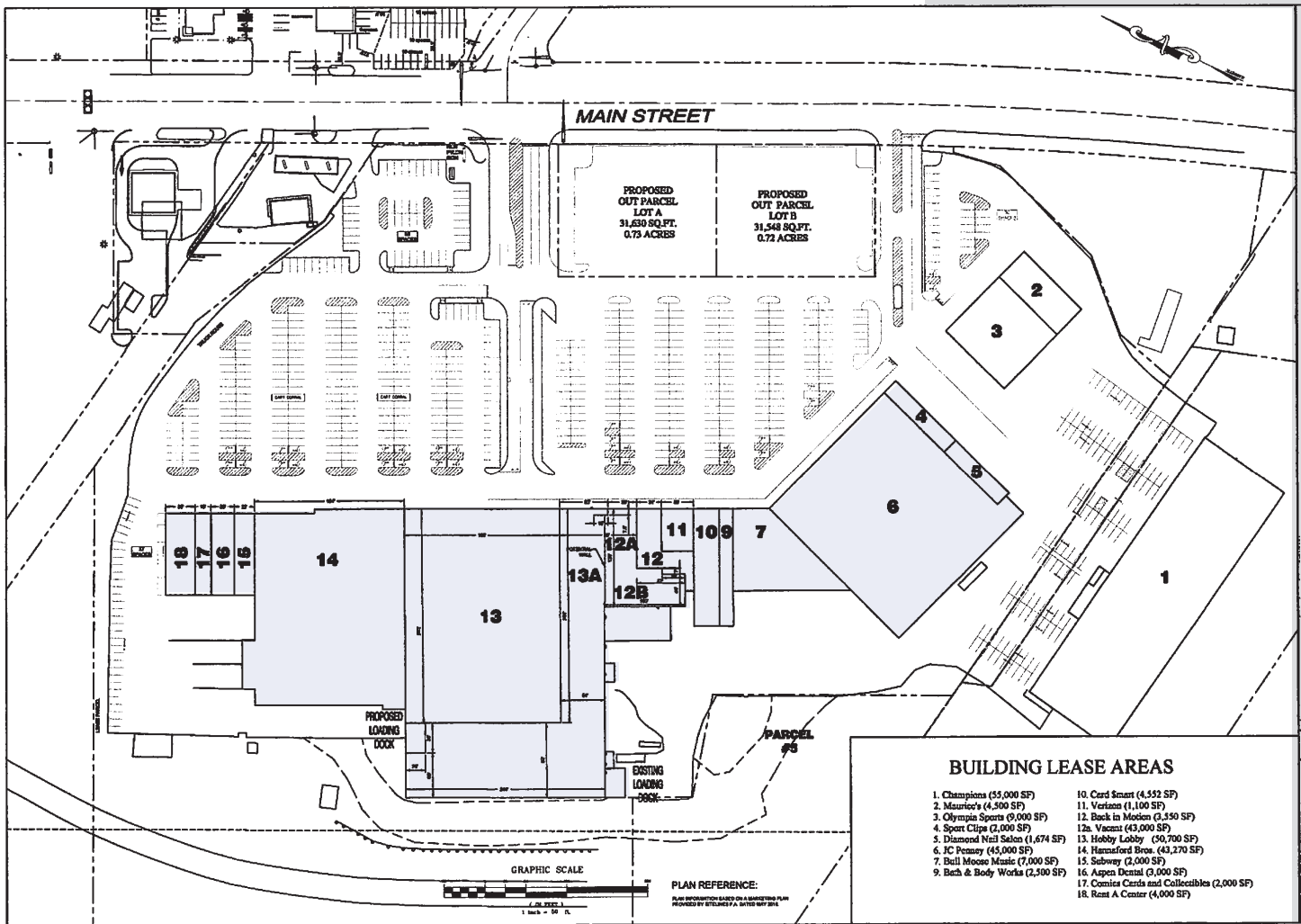

In addition to the all of the great stores already on the property, the shopping center also features:

- > 29 acres of land
- > 904 parking places
- > Center has room for expansion

Contact: Maine Crossroads LLC
Andy Rosenthal
Cell 207 415 0846
www.mainecrossroads.com • andy@mainecrossroads.com

